



CITY OF BURNET
ENGINEERING

ADDENDUM NO. 1

May 2, 2025

2024D Wood Street Improvements – RFP 2025-004
PID: CIPTR-2024D

Ladies/Gentlemen:

The City of Burnet issues this Addendum on the above captioned project. This Addendum details the changes and the respective bid document pages which were added and/or changed. Each bidder is required to acknowledge receipt of this Addendum, on the form included in the Addendum below. Failure to acknowledge receipt of this Addendum in your bid proposal will result in your bid not being read.

Please sign and **return** this Addendum with your sealed bid packet at time and location as advertised on the Invitation to Bid for this project. Addendum should be located at the beginning of the packet. Failure to acknowledge all the addenda issued will result in bid dismissal.

DESIGN ENGINEER APPROVAL:

Eric Belaj, PE, CFM
City Engineer

Addendum items and pertaining attachment will be included in the following pages.

BIDDER ADDENDUM ACKNOWLEDGMENT BELOW:

(Company Name)

(Bidder Rep. Name)

By: _____
(Signature)

Date: _____



CITY OF BURNET
ENGINEERING

1. **Bonds:** No Change
2. **Dates:** No Change
3. **Questions and Answers:** This Bid Addendum also answers questions posed by contractors throughout the bid process and at the pre-bid meeting as follows:
 - a. *Question from Bidder. See CIVAST*
 - a. Answer. See CivCast
4. **Bid Document Changes:** This item outlines changes to the Bid Documents. Attached are updated bid tab and updated set of drawings:
 - a) This addendum revises a demolition drawing for Northington Drive.
 - b) Updated and Removed previously labeled Bid Tab items 79 to 84 and item 96. Relabeled mislabeled pay `item numbers, affecting most items.Refer to the attached documents.

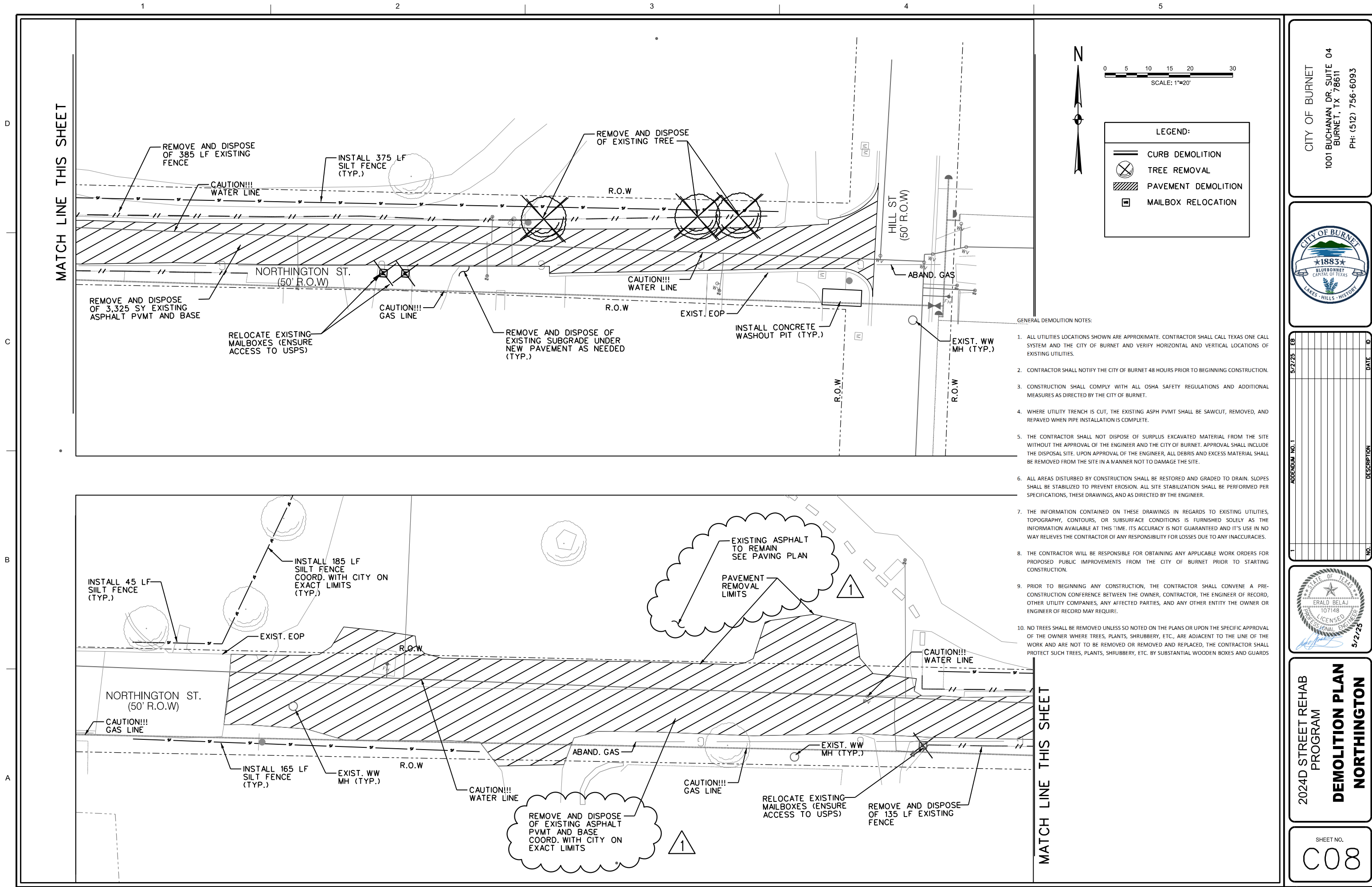

CITY OF BURNET
1001 BUCHANAN DR, SUITE 04
BURNET, TX 78611
PH: (512) 756-6093



NO.	DESCRIPTION	DATE	ID
1	APPENDUM NO. 1	5/2/25	EG



2024D STREET REHAB
PROGRAM
DEMOLITION PLAN
NORTHINGTON

SHEET NO.
C08

The *Pay Item* reference indicates the controlling specification for each Pay Item. Pay Item references are from the specifications referenced in *the Standard Form of Agreement* , unless otherwise noted.

Contractor responsible for the validity, format, and formulas in file.
PDF documents are official

PAY ITEM	DESCRIPTION	QUANTITY	UNIT	UNIT PRICE	EXTENDED PRICE
GENERAL CONDITIONS & PAVING					
1	MOBILIZATION, BONDS & INSURANCE	1	LS	\$ -	\$ -
2	TRAFFIC CONTROL WOOD ST. PHASE 1	1	LS	\$ -	\$ -
3	TRAFFIC CONTROL WOOD ST. PHASE 2	1	LS	\$ -	\$ -
4	TRAFFIC CONTROL WOOD ST. PHASE 3	1	LS	\$ -	\$ -
5	TRAFFIC CONTROL NORTHINGTON ST. PHASE 5	1	LS	\$ -	\$ -
6	TRAFFIC CONTROL NORTHINGTON ST. PHASE 6	1	LS	\$ -	\$ -
7	TRAFFIC CONTROL WOOD ST. PHASE 7	1	LS	\$ -	\$ -
8	SURVEY CONTROL	1	LS	\$ -	\$ -
9	DIGITAL MESSAGE BOARDS (PROJECT DURATION)	3	EA	\$ -	\$ -
WOOD STREET					
Demolition					
10	REMOVE AND DISPOSE OF EXIST ASPH PVMT	5,437	SY	\$ -	\$ -
11	STREET ROUGH CUT	2,102	CY	\$ -	\$ -
12	STREET CLEAR/GRUB & DISPOSE	3	AC	\$ -	\$ -
13	TEMP. RELOCATE EXIST MAILBOX(ES) (INCL. REINSTALL)	3	EA	\$ -	\$ -
14	REMOVE & DISPOSE OF EXIST. CURB AND GUTTER	2,400	LF	\$ -	\$ -
15	REMOVE & DISPOSE OF EXIST. MISC. CONRETE	206	SY	\$ -	\$ -
16	REMOVE & DISPOSE OF EXIST. TREE (W/ STUMP)	3	EA	\$ -	\$ -
17	SILT FENCE (INSTALL)	2,098	LF	\$ -	\$ -
18	SILT FENCE (REMOVAL)	2,098	LF	\$ -	\$ -
19	RELOCATE EXIST. STREET SIGN	1	EA	\$ -	\$ -
Paving					
20	CONC WASHOUT STATION	2	EA	\$ -	\$ -
21	HMAC OVERLAY (2" DEPTH) (TY-D) (NO RAP)	12,193	SY	\$ -	\$ -
22	COMPACT AND PROOF ROLL EXIST. SUBGRADE	7,568	SY	\$ -	\$ -
23	COMPACTED FLEXIBLE BASE (8" THICK)	9,064	SY	\$ -	\$ -
24	TIE-IN TO EXISTING PAVEMENT (REMOVE 1.5"X3' WIDE PVMT.)	2,680	LF	\$ -	\$ -
25	INSTALL 6" CURB & GUTTER (24"W)(INCLUDING BASE)(CURB+12")	3,530	LF	\$ -	\$ -
26	INSTALL 6" CURB & GUTTER (18"W)(INCLUDING BASE)(CURB+12")	10	LF	\$ -	\$ -
27	INSTALL RIBBON CURB (24" WIDE) (INCLUDING BASE)	770	LF	\$ -	\$ -
28	SIDEWALK (4" THICK) (WIDTH VARY) (MATCH EXIST)	112	SF	\$ -	\$ -
29	CONC. DRIVEWAY (WIDTH VARY) (DEPTH VARY)	4,243	SF	\$ -	\$ -
30	CONCRETE SPILLWAY FLUME (6" CURB) (6' WIDE)	195	SF	\$ -	\$ -
31	CONCRETE VALLEY GUTTER (MATCH EXIST)	2	EA	\$ -	\$ -
32	CONCRETE VALLEY GUTTER (36" WIDE)	293	LF	\$ -	\$ -
33	MISC. GRADING TO DRAIN	1	LS	\$ -	\$ -
34	INSTALL MH RISER RING INSERT (INCL. TACK WELDING& LID)	2	EA	\$ -	\$ -
35	INSTALL VALVE RISER RING INSERT (INCL. LID IF NEEDED)	1	LS	\$ -	\$ -
36	REVEG DISTURBED AREAS (HYDROMULCH) (CURLEX SLOPES)	1,354	SY	\$ -	\$ -
Pavement Markings					
37	BLUE TRAFFIC BUTTON REFLECTORS	4	EA	\$ -	\$ -
38	SOLID WHITE 24" x 14' THERMOPLASTIC MARKER (STOP BAR)	5	EA	\$ -	\$ -
39	THERMOPLACTIC TRAFFIC SYMBOL (WHITE) (ARROW)	3	EA	\$ -	\$ -
40	THERMOPLACTIC TRAFFIC SYMBOL (WHITE) (ONLY)	1	EA	\$ -	\$ -
41	SOLID YELLOW SOLID THERMOPLASTIC STRIPING (4" WIDE)	518	LF	\$ -	\$ -
42	YELLOW TRAFFIC BUTTON REFLECTORS (20' SPACING)	26	EA	\$ -	\$ -
43	SOLID WHITE SOLID THERMOPLASTIC STRIPE (6" WIDE)	145	LF	\$ -	\$ -

The *Pay Item* reference indicates the controlling specification for each Pay Item. Pay Item references are from the specifications referenced in *the Standard Form of Agreement* , unless otherwise noted.

Contractor responsible for the validity, format, and formulas in file.
PDF documents are official

PAY ITEM	DESCRIPTION	QUANTITY	UNIT	UNIT PRICE	EXTENDED PRICE
GENERAL CONDITIONS & PAVING					
NORTHINGTON STREET					
Demolition					
44	REMOVE AND DISPOSE OF EXIST ASPH PVMT	3,322	SY	\$ -	\$ -
45	STREET ROUGH CUT	742	CY	\$ -	\$ -
46	STREET CLEAR/GRUB & DISPOSE	1	AC	\$ -	\$ -
47	TEMP. RELOCATE EXIST MAILBOX(ES) (INCL. REINSTALL)	3	EA	\$ -	\$ -
48	REMOVE & DISPOSE OF EXIST. CURB AND GUTTER	2	LF	\$ -	\$ -
49	REMOVE & DISPOSE OF EXIST. TREE (W/ STUMP)	3	EA	\$ -	\$ -
50	REMOVE & DISPOSE OF EXIST. FENCE (1' BELOW GRADE)	520	LF	\$ -	\$ -
51	SILT FENCE (INSTALL)	765	LF	\$ -	\$ -
52	SILT FENCE (REMOVAL)	765	LF	\$ -	\$ -
Paving					
53	CONC WASHOUT STATION	1	EA	\$ -	\$ -
54	HMAC OVERLAY (2" DEPTH) (TY-D) (NO RAP)	3,896	SY	\$ -	\$ -
55	PARKING LOT HMAC OVERLAY (2" DEPTH) (TY-D) (NO RAP)	2,749	SY	\$ -	\$ -
56	COMPACT AND PROFF ROLL EXIST. SUBGRADE	2,670	SY	\$ -	\$ -
57	COMPACTED FLEXIBLE BASE (8" THICK)	2,323	SY	\$ -	\$ -
58	TIE-IN TO EXISTING PAVEMENT (REMOVE 1.5"X3' WIDE PVMT.)	805	LF	\$ -	\$ -
59	INSTALL 6" CURB & GUTTER (18"W)(INCLUDING BASE)(CURB+12")	1,278	LF	\$ -	\$ -
60	INSTALL RIBBON CURB (18" WIDE) (INCLUDING BASE)(CURB+12")	801	LF	\$ -	\$ -
61	PARKING RIBBON CURB (18" WIDE) (INCLUDING BASE)(CURB+12")	639	LF	\$ -	\$ -
62	SIDEWALK (4" THICK) (WIDTH VARY) (MATCH EXIST)	29	SF	\$ -	\$ -
63	ASPHALT DRIVEWAY (WIDTH VARY) (DEPTH VARY) (4" BASE)	98	SY	\$ -	\$ -
64	MISC. GRADING TO DRAIN	1	LS	\$ -	\$ -
65	INSTALL MH RISER RING INSERT (INCL. TACK WELDING& LID)	2	EA	\$ -	\$ -
66	INSTALL VALVE RISER RING INSERT (INCL. LID IF NEEDED)	1	LS	\$ -	\$ -
67	REVEG DISTURBED AREAS (HYDROMULCH) (CURLEX SLOPES)	167	SY	\$ -	\$ -
68	LIMESTONE BLOCK WALL (1 ROW) (GRAY ROCK)	164	LF	\$ -	\$ -
69	UNREINF CONC. WALL BASE (3' WIDE) (6" THICK)	164	LF	\$ -	\$ -
70	STEEL PANNEL FENCE OVER WALL (5'-6' TALL) (INCL ANCHOR)	263	LF	\$ -	\$ -
Pavement Markings					
71	BLUE TRAFFIC BUTTON REFLECTORS	1	EA	\$ -	\$ -
72	SOLID WHITE 24" x 14' THERMOPLASTIC MARKER (STOP BAR)	3	EA	\$ -	\$ -
73	SOLID WHITE THERMOPLASTIC PARKING LOT STRIPING (4" WIDE)	925	LF	\$ -	\$ -
74	SOLID WHITE THERMOPLASTIC SYMBOL (ARROW)	0	EA	\$ -	\$ -
75	ADA ACCESIBLE PARKING SPOT SYMBOL (W/ VAN)	0	EA	\$ -	\$ -
TOTAL BASE BID (TOTAL OF ITEMS IN THE COLUMNS ABOVE)				\$	-

The *Pay Item* reference indicates the controlling specification for each Pay Item. Pay Item references are from the specifications referenced in *the Standard Form of Agreement* , unless otherwise noted.

Contractor responsible for the validity, format, and formulas in file.
PDF documents are official

PAY ITEM	DESCRIPTION	QUANTITY	UNIT	UNIT PRICE	EXTENDED PRICE
GENERAL CONDITIONS & PAVING					
ADDED BID ALTERNATE NO. 1: BOUNDARY STREET					
GENERAL CONDITION & PAVING					
76	MOBILIZATION, BONDS & INSURANCE	1	LS	\$ -	\$ -
77	TRAFFIC CONTROL BOUNDARY ST. PHASE 4	1	LS	\$ -	\$ -
78	INSTALL VALVE RISER RING INSERT (INCL. LID IF NEEDED)	1	LS	\$ -	\$ -
Demolition					
79	REMOVE AND DISPOSE OF EXIST ASPH PVMT	846	SY	\$ -	\$ -
80	STREET ROUGH CUT	272	CY	\$ -	\$ -
81	STREET CLEAR/GRUB & DISPOSE	1	AC	\$ -	\$ -
82	TEMP. RELOCATE EXIST MAILBOX(ES) (INCL. REINSTALL)	2	EA	\$ -	\$ -
83	REMOVE & DISPOSE OF EXIST. CURB AND GUTTER	2	LF	\$ -	\$ -
84	REMOVE & DISPOSE OF EXIST. MISC. CONRETE	4	SY	\$ -	\$ -
85	REMOVE & DISPOSE OF EXIST. TREE (W/ STUMP)	2	EA	\$ -	\$ -
86	SILT FENCE (INSTALL)	300	LF	\$ -	\$ -
87	SILT FENCE (REMOVAL)	300	LF	\$ -	\$ -
Paving					
88	CONC WASHOUT STATION	1	EA	\$ -	\$ -
89	HMAC OVERLAY (2" DEPTH) (TY-D) (NO RAP)	809	SY	\$ -	\$ -
90	COMPACT AND PROFF ROLL EXIST. SUBGRADE	977	SY	\$ -	\$ -
91	COMPACTED FLEXIBLE BASE (8" THICK)	809	SY	\$ -	\$ -
92	TIE-IN TO EXISTING PAVEMENT (REMOVE 1.5"X3' WIDE PVMT.)	30	LF	\$ -	\$ -
93	INSTALL 6" CURB & GUTTER (24"W)(INCLUDING BASE)(CURB+12")	603	LF	\$ -	\$ -
94	SIDEWALK (4" THICK) (WIDTH VARY) (MATCH EXIST)	28	SF	\$ -	\$ -
95	CONC. DRIVEWAY (WIDTH VARY) (DEPTH VARY)	816	SF	\$ -	\$ -
96	MISC. GRADING TO DRAIN	1	LS	\$ -	\$ -
97	INSTALL VALVE RISER RING INSERT (INCL. LID IF NEEDED)	1	LS	\$ -	\$ -
98	REVEG DISTURBED AREAS (HYDROMULCH) (CURLEX SLOPES)	167	SY	\$ -	\$ -
Pavement Markings					
99	SOLID WHITE 24" x 14' THERMOPLASTIC MARKER (STOP BAR)	1	EA	\$ -	\$ -
TOTAL BID ALT. NO. 1				\$	-

TOTAL BASE BID INCLUDING ADDITIONAL BID ITEMS (TOTAL OF ITEMS IN THE COLUMNS ABOVE)	\$ -
The total bid shall be entered in the space provided above, and shall also be entered in the space provided in the Bid Summary Sheet. All construction shall be completed per the City of Burnet's Technical Construction Standard Manual. Contractor will be required to provide insurance certificate and performance bonds per the specs.	Payment for all Items shall be base on Plans Quantity , as described in <i>Measurement and Payment</i> , unless otherwise noted.